



T H E R M O M E T R I C S
A C O M M I T M E N T T O E X C E L L E N C E

A-2152

Plug Detection Sensor



Thermometrics A-2152 Plug Detection Sensor is subjected to a specific voltage to promote heating of the sensing element. This is combined with the end user's fluid running past the sensor, which causes the sensor to cool down until a plug or loss in flow rate occurs. The sensor element will alert the system when a specific resistance is met for self-heating i.e., plug or loss in flow rate.

Applications

- Agriculture / Heavy Equipment
- Automotive HVAC Monitoring

Features

- High sensitivity
- Compact design
- Other resistance and beta values possible

Amphenol
Advanced Sensors

A-2152 Specifications

Operating Temperature Range:

-20°C to 85°C

Storage Temperature:

-55°C to 85°C

R @ 25°C:

200 Ω ± 2.0%

Beta (25/80) °C:

3449.37

Response Time:

Less than 15 seconds

Housing Material:

316 Stainless Steel

Weight:

5.8 Grams

Flow Range:

0-6 lpm

R vs. T			
Temp (°C)	Resistance (Ω)	Resistance Tolerance (±%)	Tolerance (±°C)
-40	4199	5.01	0.9
-20	1428	3.95	0.8
0	558	3.02	0.7
25	200	2.0	0.5
40	116	2.58	0.7
60	59.7	3.23	1.0
80	33.0	3.82	1.4
100	19.4	4.36	1.7

Dimensions

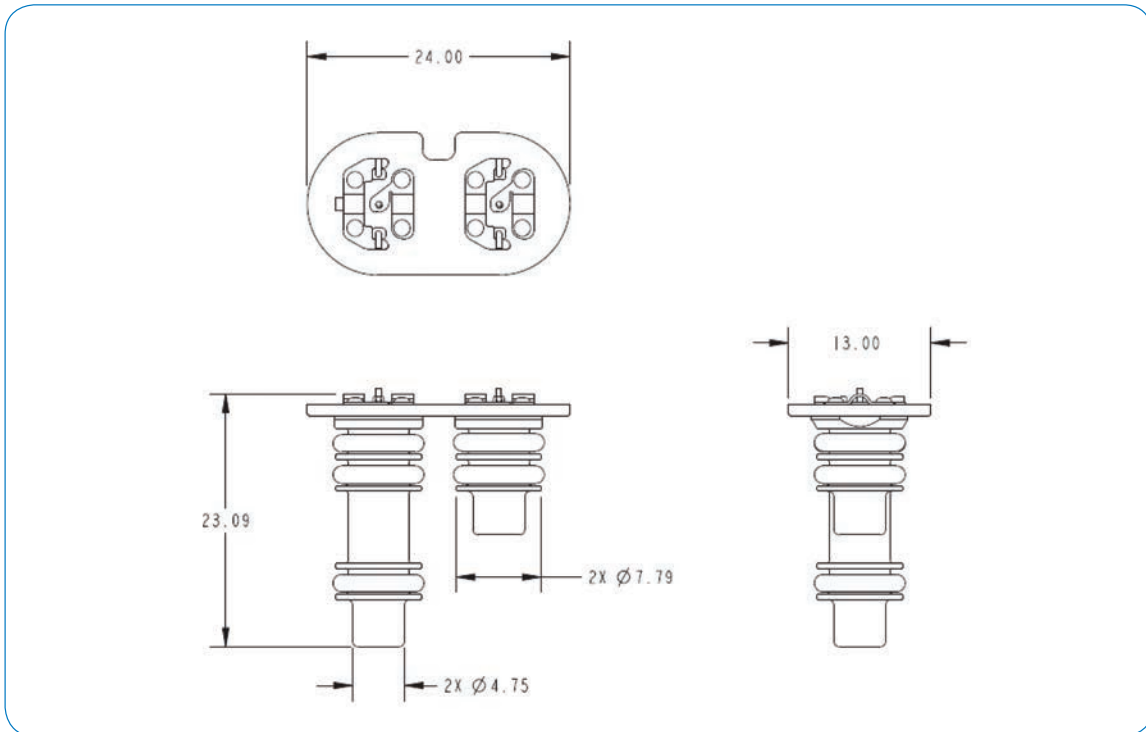

Amphenol
Advanced Sensors

www.amphenol-sensors.com

© 2019 Amphenol Corporation. All Rights Reserved. Specifications are subject to change without notice. Other company names and product names used in this document are the registered trademarks or trademarks of their respective owners.

AAS-920-752A - 05/2019